

Contactless Sensor Tap

Model : T-102



T-102 Tap is an Ergonomically Swan Neck Design. It offers touch free convenience and ensuring reduces the spread of germs and bacteria. This Tap help prevent water wastage, saving water efficiently with smart flow control, lowering your bills and environmental impact. No need to touch the Tap, making it easier for children and the elderly to use. Experience superior hygiene, efficiency, and cost saving with our innovative solution.

Technical Parameters :

Dimension	: L-190, Distance of premix from bottom-100 mm, Control Box: L-124 mm, W-90 mm, D-54 mm
Material	: Chrome Plated Brass Metal Body
Power	: 220V AC / DC 6V - 4xAA Alkaline Batteries
Application Area	: Basin Mounted
Sensing Range	: 150 mm Adjustable
Water Pressure	: 0.02 Mpa-0.8 Mpa, *0.05 Mpa is minimum Required Pressure for Decent Flow of Water
Volume of Water per minute	: 1.2 lit/min to 2-3 lit/min (based on water pressure)
Protection	: IP56
Ambient Temperature	: 0.1°C - 50°C
Dia of Inlet & Outlet	: DN 15 (1/2 inch BMP)
USP	: Stylish & Sleek Front Sensor



NATURE HYGIENE
ENTRANCE/AUTOMATIONS

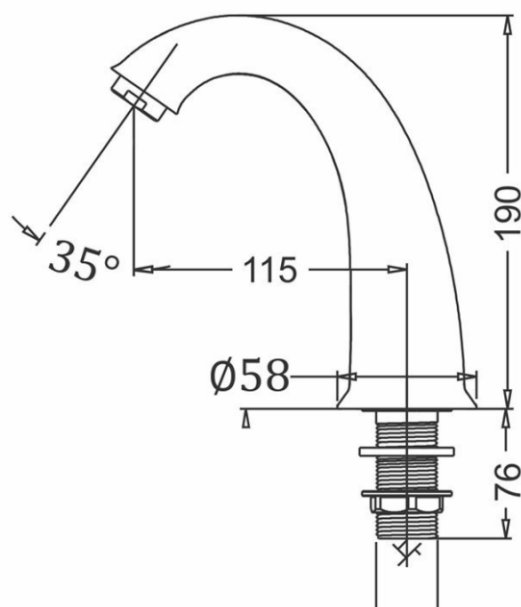
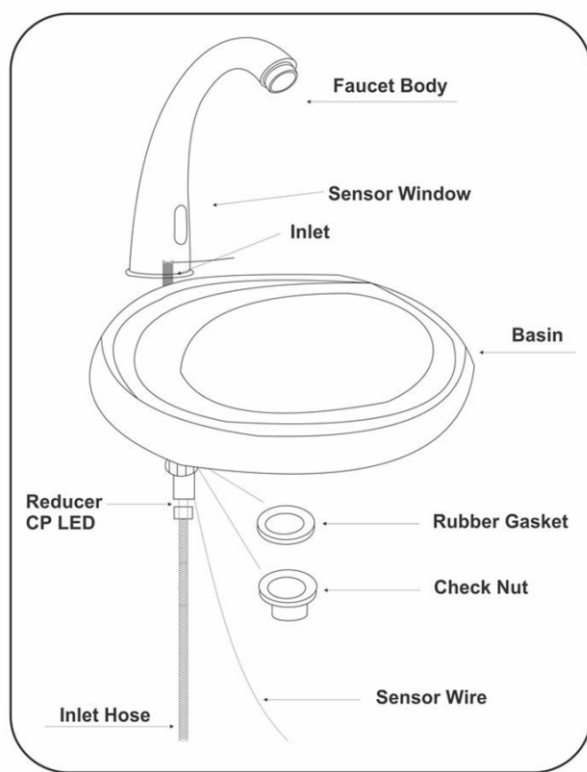

Nature Hygiene & Entrance Automations

580/1, Link Road, Sahibabad Industrial Area,
Site-IV, Ghaziabad, Uttar Pradesh - 201010

GSTIN: 09BIQPK3964G1ZQ | MSME No: UDYAM-UP-29-0097857 | IEC No: BIQPK3964G | AN ISO 9001:2015 & CE CERTIFIED COMPANY

✉ sales@naturehygieneindia.com
🌐 www.naturehygieneindia.com
☎ +91-8130817304



Delhi NCR



Chandigarh



Jaipur



Vadodra



Bengaluru



Pune



Mumbai